

## Zips 6 & 12 Port Alarm Box Installation



- 1 Determine where the Alarm Box(es) will be placed. Use the provided alcohol wipe to clean the area and allow it to dry completely.

**Note:** Alarm Boxes are intended to be placed below a counter.



- 2 Peel the clear film from the 2 adhesives on the bottom of the Alarm Box.

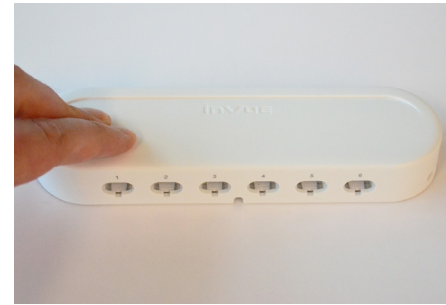

- 3 Place the Alarm Box where previously determined and apply pressure for at least 10 seconds.

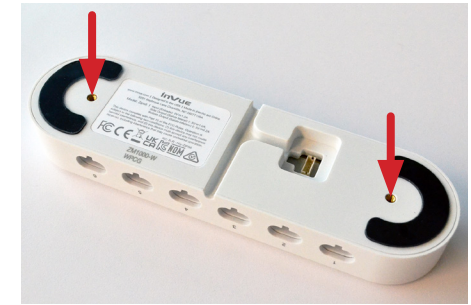

- 4 **Optional:** Alarm Boxes can also be mounted using the screw inserts on the bottom of the Alarm Box and M3 studs or screws (not supplied by InVue).

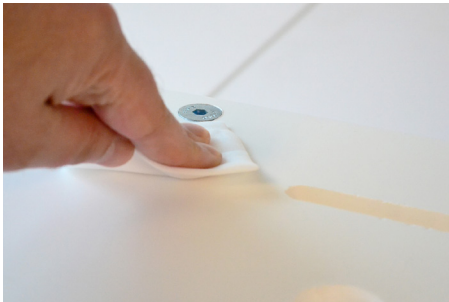

- 5 Choose an easily accessible location for the IR Dot placement and use the provided alcohol wipe to clean the surface. Allow it to dry completely.

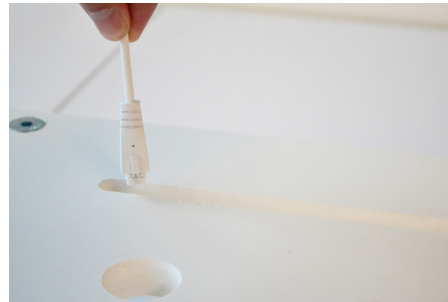

- 6 Route the IR Dot cable to where the Alarm Box was placed.



- 7 Plug the the IR Dot into the Alarm Box.  
**Note:** If installing multiple Boxes the IR Dot will always plug into the first Box in the series.

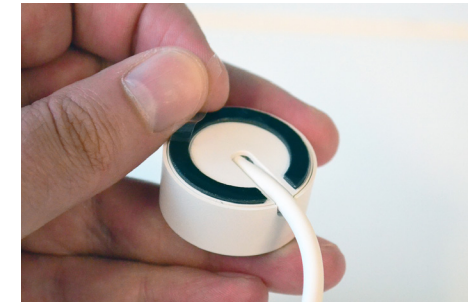

- 8 Peel the clear film from the adhesive on the bottom of the IR Dot.

## Zips 6 & 12 Port Alarm Box Installation

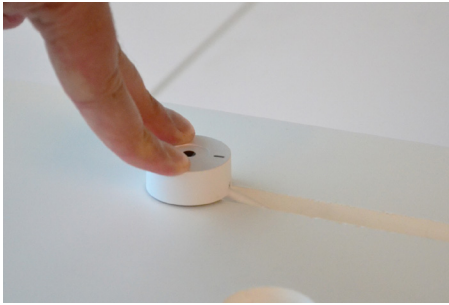

- 9 Place the IR Dot where previously determined and apply pressure for at least 10 seconds.



- 10a **Optional:** If installing multiple Alarm Boxes (up to 4 can be installed in a series). Plug the micro-USB side of the ZM1050 connector cable into the port on the first Alarm Box.

**Note:** A ZM1050 cable is needed to connect each Alarm Box in the series.



- 10b Plug the other end of the ZM1050 cable into the left side of the next Alarm Box in the line.



- 11 Plug the PS512 power supply into the port on the right side of the Alarm Box (or final Alarm Box in the series).



- 12 Plug the other end of the power supply into a power outlet.



- 13 Route the sensor(s) that has been installed to merchandise to where the Alarm Box(es) are located.



- 14 Plug the sensor(s) into the Alarm Box.



- 15 **Optional:** If using a legacy sensor, plug the sensor into an adaptor and plug the adaptor into the Alarm Box.

## ▶ Zips 6 & 12 Port Alarm Box Installation

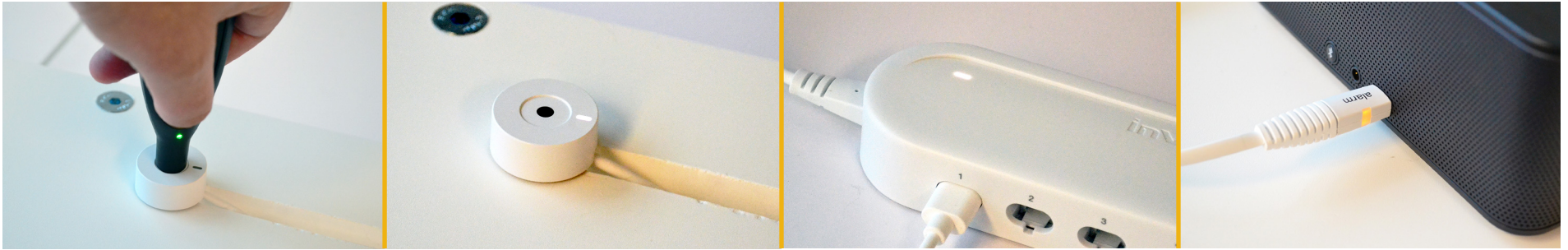

- 16 Place a charged and coded OneKEY onto the IR Dot and press the button on the Key to code the system. The system will chirp in confirmation. After 30 seconds, the LEDs on the IR Dot, Alarm Box and the sensor (if an LED is present), will all illuminate to indicate that the system is connected and armed.

### Usage & Remerchandising Steps



- 17 To disarm the system, place a charged and coded OneKEY onto the IR Dot and press the button. The system will be disarmed for 30 seconds.
- 18 Within the 30 second disarm-window, remove the sensor or adaptor from the position that will be serviced.
- 19 Remerchandise or replace the sensor or adaptor for that position.
- 20 Plug the sensor or adaptor back into the Alarm Box. All Alarm Boxes with armed sensors that are part of the system will chirp in confirmation and rearm.

**Note:** This method is also used to silence the alarm during an alarm event.

**Note:** When a sensor is removed from an Alarm Box, the other positions will automatically rearm. The system will need to be disarmed again for each position that needs to be serviced.

## Zips 6 & 12 Port Alarm Box Installation

### Removal Steps

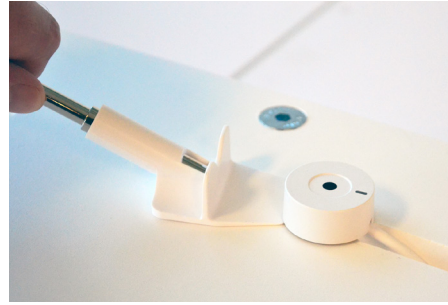

**21** After deactivating the system and unplugging all cables, insert the DNTX93 scraper removal tool between the adhesive on the Alarm Box and the surface. Work the removal tool back and forth to break the adhesive bond.

**22** Repeat the process for the IR Dot.